



## **AGENDA**

### **CHARTER AUTHORIZING PANEL**

July 19, 2017

Arkansas Department of Education

ADE Auditorium

8:30 AM

#### **I. Reports**

Presenter: Deborah Coffman

##### **1. Chair's Report**

##### **2. Charter Schools Unit Report**

As of July 7, 2017, there are 10 active applications petitioning for open-enrollment charters. With this number of applications, the Charter Unit would like to discuss the upcoming application hearings, which will occur in August.

Presenter: Alexandra Boyd and Jennifer Davis

#### **II. Consent Agenda**

##### **1. Minutes - May 17, 2017**

3

Presenter: Freddie Scott

#### **III. Action Agenda**

##### **1. Request for Open-Enrollment Charter School Amendment: KIPP Delta 5**

Public Schools

On March 11, 2002, the State Board of Education approved the application for KIPP Delta Public Schools. The charter is approved to serve students in grades K-12 with a maximum enrollment of 2,310.

Representatives of KIPP Delta Public Schools are appearing before the Charter Authorizing Panel to request an amendment to the current charter.

Presenter: Virginia Perry

##### **2. Request for Open-Enrollment Charter School Amendment: The Excel 28**

Center

On October 19, 2016, the State Board of Education approved the application for The Excel Center. The charter is approved to serve students in grades 9-12 with a maximum enrollment of 125.

Representatives of The Excel Center are appearing before the Charter Authorizing Panel to request an amendment to the current charter.

Presenter: Virginia Perry

**Minutes  
Charter Authorizing Panel  
May 17, 2017**

The Charter Authorizing Panel met on Wednesday, May 17, 2017, in the auditorium of the Department of Education building. Deborah Coffman, Chair, called the meeting to order at 8:33 a.m.

Present: Deborah Coffman, chair Dr. Mark Gotcher, Vice Chair (Action Items 2-5), Stacy Smith; Bobby Lester; Dr. Ivy Pfeffer; Greg Rogers;

Absent: Annette Barnes; Dr. Eric Saunders; Lisa Haley

The transcription of this meeting may be accessed on the Arkansas Department of Education website at the following:

<http://www.arkansased.gov/about-ade/charter-authorizing-panel/minutes/archive/2016>

**Reports**

Ms. Coffman welcomed the members of the Panel and the audience.

Ms. Coffman provided the audience with instructions pertinent to the proceedings. There were no reports provided.

**Consent Agenda**

It was moved by Dr. Gotcher and seconded by Dr. Pfeffer and carried unanimously to approve the consent agenda.

Items included in the Consent Agenda: Minutes- April 19, 2017.

**Action Agenda**

Staff Attorney Jennifer Davis provided the Panel with directions for the proceedings. She also explained the public voting procedures to the Panel and the audience.

**A-1 Request for Open-Enrollment Public Charter School Amendment: Exalt Academy of Southwest Little Rock**

Ms. Christina Long, Superintendent, presented the Panel with the Exalt Academy of Southwest Little Rock request.

A question and answer period followed.

It was moved by Dr. Pfeffer, seconded by Dr. Gotcher, and carried unanimously to approve the amendment request.

**A-2 Request for Open-Enrollment Public Charter School Amendment: Little Rock Preparatory Academy**

Ms. Christina Long, Superintendent, presented the Panel with the Little Rock Preparatory Academy amendment request.

A question and answer period followed.

It was moved by Dr. Gotcher, seconded by Mr. Rogers, and carried unanimously to approve the amendment request.

**A-3 Request for Open-Enrollment Public Charter School Amendment: Arkansas Virtual Academy**

Dr. Scott Sides, Superintendent, presented the Panel with the Arkansas Virtual Academy amendment request.

A question and answer period followed.

It was moved by Dr. Gotcher, seconded by Dr. Pfeffer, and carried with a unanimous vote to approve the amendment request.

**Report**

**2. Charter Office Proposal to Develop and Implement Annual Reporting**

Director Alexandra Boyd presented a proposal to provide a comprehensive Annual Reporting system for charters.

Discussion followed.

**Adjournment**

It was moved by Dr. Gotcher, seconded by Mr. Rogers, and carried unanimously to adjourn.

The meeting adjourned at 9:27 a.m.

*Minutes recorded by Freddie Scott*

---

Deborah Coffman, Charter Authorizing Panel Chair

**KIPP DELTA PUBLIC SCHOOLS**  
SPONSORING ENTITY: KIPP DELTA, INC.

**CURRENT DATA**

Maximum Enrollment	2,310
Approved Grade Levels	K-12
Grades Served 2016-2017	K-12

**2016-2017 Enrollment by Race**

Two or More Races	6
Asian	14
Black	1267
Hispanic	33
Native American/Native Alaskan	0
Native Hawaiian/Pacific Islander	0
White	70
<b>Total</b>	<b>1390</b>

**2016-2017 Enrollment by Grade**

Kindergarten	73
1st Grade	82
2nd Grade	76
3rd Grade	78
4th Grade	112
5th Grade	166
6th Grade	193
7th Grade	115
8th Grade	124
9th Grade	118
10th Grade	116
11th Grade	85
12th Grade	51

**2016-2017 Student Status Counts**

Migrant	0
LEP	4
Gifted & Talented	1
Special Education	91
Title I	1389
Source: District Cycle 4 Report	

**2015-2016 Average Daily Attendance**

	Q1	Q2	Q3	Q4
ADA	1356.77	1350.28	131.14	1275.37
ADM	1400.51	1397.33	1373.25	1357.16
%	96.88%	96.63%	9.55%	93.97%

**BACKGROUND**

Authorized	March 11, 2002
Grade levels	K-12
Maximum Enrollment	2,310
Length of Contract	Ten Years
Contract End Date	June 30, 2023

<b>Amendment Request Considered and APPROVED</b> Relocate KIPP Delta campus	September 12, 2004
<b>Renewal Request</b> Renewed for 3 years Amendment denied - add grades 9-12 to KIPP Delta	March 14, 2005
<b>Amendment Request Considered and APPROVED</b> Addition of grades 9-12 to KIPP Delta and increase enrollment cap	April 9, 2007
<b>Renewal Request</b> Renewed for 5 years Amendment approved to waive the following: Standards for Accreditation 19.03 ADE Rules Governing Uniform Grading Scales	March 10, 2008
<b>Amendment Request Considered and APPROVED</b> Addition of K-4 to Helena	October 13, 2008
<b>Amendment Request Considered and APPROVED</b> Addition of Blytheville license	November 9, 2009
<b>Amendment Request Considered and APPROVED</b> Additional Waivers for the following: 6-13-619(a)(1) 6-15-902(a) 6-17-114 Remove Waivers for the following: 6-17-1001 6-17-1002	July 12, 2010
<b>Amendment Request Considered and APPROVED</b> Add 4th grade to Blytheville and relocate campus	May 14, 2012
<b>Renewal Request</b> Renewed for 10 years Amendment approved to waive the following: 6-13-109 6-13-601 et. seq. 6-15-1005(b)(5) 6-15-1603 6-17-201(c)(2) 6-17-309 6-17-427 6-17-2203 6-18-503(a)(1)(c)(i) 6-18-1001 et. seq. 6-20-2208(c)(6)	March 11, 2013

6-25-103

6-25-104

6-42-101 et. seq.

Standards for Accreditation 19.03

ADE Rules Governing Parental Notification of an Assignment of a Non-Licensed Teacher

ADE Rules Governing the Superintendent Mentoring Program

Section 4 of the ADE Rules Governing the Distribution of Student Special Needs Funding

ADE Rules Governing School District Requirements for Personnel Policies, Salary Schedules, Minimum Salaries, and Documents Posted to District Websites

Amendment approved - Add 3rd grade to Blytheville and increase enrollment by 90

**Amendment Request Considered and APPROVED**

November 20, 2013

Add 9-12 to Blytheville and increase enrollment

Additional Waiver of 6-13-619 (c)(1)(A) and 6-15-902(c)(2)

**Amendment Request Considered and APPROVED**

February 13, 2014

Additional Waivers for the following:

6-13-635

6-17-1304

6-17-2205

Change to school day start time

**Amendment Request Considered and APPROVED**

November 13, 2014

Addition of Forrest City license

**Amendment Request Considered and APPROVED**

February 18, 2015

Change of address Forrest City campus

**Amendment Request Considered and APPROVED**

February 19, 2016

Change grades of Blytheville College Prep from 4-8 to 4-6

Change grades of Blytheville Collegiate High from 9-10 to 7-12

Establish new campus at 1124 West Moultrie Drive to be used for elementary



# KIPP DELTA PUBLIC SCHOOLS

415 Ohio Street  
Helena-West Helena  
Arkansas, 72342  
Phone: 870.753.9035  
Fax: 870.753.9440  
[www.kippdelta.org](http://www.kippdelta.org)

Scott Shirey  
KIPP Delta Public Schools  
415 Ohio Street  
Helena, AR 72342

June 6, 2017

Commissioner Johnny Key  
Arkansas Department of Education  
Four Capitol Mall, Room 304-A  
Little Rock, AR 72201

Dear Commissioner Key,

I hope this letter finds you well. KIPP Delta is seeking an expedited charter amendment request that allows KIPP Delta to expand its schools in Blytheville to serve students in Kindergarten – third grade. Our Blytheville campuses are currently approved to serve students in grades 4 – 12 with a maximum enrollment of 810. Our desire is to expand to K – 12 with a maximum enrollment of 1,100 beginning in the 2018 – 2019 school year. We are seeking an expedited approval outside of the normal process because there are several advantageous financing options that are contingent upon this approval. An October approval would significantly delay the approval of these loans. In July, we plan to submit a request for the associated debt.

Ms. Alexandra Boyd, Director of the Public Charter Schools Office, advised that we reach out to you to waive ADE Rules Governing Public Charter Schools section 4.02.3 in accordance with ADE Rules Governing Public Charter Schools section 4.02.7 and allow us to present our amendment request at the July 19, 2017 Charter Authorizing Panel meeting. Please let this letter serve as our official request for you to grant the necessary approvals to allow KIPP Delta to present on July 19<sup>th</sup>.

We appreciate your flexibility. Please let us know if you have any questions.

Sincerely,

Scott Shirey  
Executive Director  
KIPP Delta Public Schools

cc: Charity Hallman, KIPP Delta Finance Director  
Chintan Desai, KIPP Delta Project Manager  
Scott Smith, Arkansas Public School Resource Center Executive Director  
Alexandra Boyd, Arkansas Department of Education Director of the Public Charter Schools Office  
Virginia Perry, Arkansas Department of Education Public Charter Schools Office Program Advisor  
Richard Atwill, Blytheville School District Superintendent

**KIPP DELTA  
COMMUNITIES**

HELENA-WEST  
HELENA

BLYTHEVILLE

FORREST CITY





**Charter Amendment Request Form**

**Charter Name:** KIPP Delta Public Schools  
**LEA Number:** 5440700      **Phone Number:** 870-753-9035      **Submission Date:** 06/13/2017  
**Charter Leader:** Scott Shirey  
**Email Address:** scott.shirey@kipdelta.org

**Type of Amendment Requested:**

☒ **Add a new campus**

**Address** 1124 Moultrie Drive  
Blytheville, AR 72315

**School district in which the campus will be located** Blytheville School District

☒ **Increase enrollment cap**

**Current cap** 810

**Proposed cap** 1100

☒ **Change grade levels served**

**Current grade levels served** 4 - 12

**Proposed grade levels** K - 12

# KIPP Delta Public Schools

## ENROLLMENT REPORT

Enrollment Date: May 26, 2017

Enrollment Count		01	02	03	04	05	06	07	08	09	10	11	12	KF	SS	Race Totals
Asian	Females						1		2		1	1				5
	Males					1	1	1		1	1	2		1		8
	<b>Gender Totals</b>					<b>1</b>	<b>2</b>	<b>1</b>	<b>2</b>	<b>1</b>	<b>2</b>	<b>3</b>		<b>1</b>		<b>13</b>
Black	Females	40	42	44	52	68	85	49	53	51	50	43	25	27	1	630
	Males	35	30	29	47	72	79	59	56	52	43	31	20	38		591
	<b>Gender Totals</b>	<b>75</b>	<b>72</b>	<b>73</b>	<b>99</b>	<b>140</b>	<b>164</b>	<b>108</b>	<b>109</b>	<b>103</b>	<b>93</b>	<b>74</b>	<b>45</b>	<b>65</b>	<b>1</b>	<b>1,221</b>
Hispanic	Females		1		3	5	3		1	1						14
	Males	2		1	3		3	1	2					1		13
	<b>Gender Totals</b>	<b>2</b>	<b>1</b>	<b>1</b>	<b>6</b>	<b>5</b>	<b>6</b>	<b>1</b>	<b>3</b>	<b>1</b>				<b>1</b>		<b>27</b>
Native American	Females											1				1
	<b>Gender Totals</b>											<b>1</b>				<b>1</b>
Two or More	Females						1					2				3
	Males							1	1		1					3
	<b>Gender Totals</b>						<b>1</b>	<b>1</b>	<b>1</b>		<b>1</b>	<b>2</b>				<b>6</b>
White	Females	1	3	1	4	8	5	2	3	2	3	5		2		39
	Males	2	2	2	2	2	4	2	3	4	2			5		30
	<b>Gender Totals</b>	<b>3</b>	<b>5</b>	<b>3</b>	<b>6</b>	<b>10</b>	<b>9</b>	<b>4</b>	<b>6</b>	<b>6</b>	<b>5</b>	<b>5</b>		<b>7</b>		<b>69</b>
<b>Grade Totals</b>		<b>80</b>	<b>78</b>	<b>77</b>	<b>111</b>	<b>156</b>	<b>182</b>	<b>115</b>	<b>121</b>	<b>111</b>	<b>101</b>	<b>85</b>	<b>45</b>	<b>74</b>	<b>1</b>	<b>1,337</b>

# KIPP Delta Public Schools

## Student Demographic Percentages

Excludes PK Students

1,337 Total Active Students On 06/01/2017

### District Gender Percentages

Gender	Gender Count	Gender Percentage
Females	692	51.76%
Males	645	48.24%
<b>Gender - Total</b>	<b>1,337</b>	<b>100.00%</b>

### District Primary Race Percentages

Race	Race Count	Race Percentage
Asian	13	0.97%
Black	1,221	91.32%
Hispanic or Latino	27	2.02%
Native American/Alaskan Native	1	0.07%
Two or More Races	6	0.45%
White	69	5.16%
<b>Primary Race - Total</b>	<b>1,337</b>	<b>100.00%</b>

### District Curriculum Percentages

Curriculum Name	Curriculum Count	Curriculum Percentage
Regular Student	1,337	100.00%
<b>Curriculum - Total</b>	<b>1,337</b>	<b>100.00%</b>

### District G/T Percentages

G/T	G/T Count	G/T Percentage
No	1,337	100.00%
<b>G/T - Total</b>	<b>1,337</b>	<b>100.00%</b>

### District Special Ed Percentages

Special Ed	SPED Count	SPED Percentage
Active	146	10.92%
Inactive	36	2.69%
No	1,155	86.39%
<b>Special Education - Total</b>	<b>1,337</b>	<b>100.00%</b>

### District 504 Percentages

504	504 Count	504 Percentage
No	1,321	98.80%
Yes	16	1.20%
<b>504 - Total</b>	<b>1,337</b>	<b>100.00%</b>

### District Meal Status Percentages

Meal Status Code	Meal Status Count	Meal Status Percentage
01	581	43.46%
04	756	56.54%
<b>Meal Status - Total</b>	<b>1,337</b>	<b>100.00%</b>

### District Residency Percentages

Residency Name	Residency Count	Residency Percentage
Resident/District	1,221	91.32%
School Choice, Not First Time	116	8.68%
<b>Residency - Total</b>	<b>1,337</b>	<b>100.00%</b>

### District Homeless Percentages

Homeless Status	Homeless Count	Homeless Percentage
Doubled Up	13	0.97%
Not Applicable	1,321	98.80%
Shelter - Transitional House	1	0.07%
Unsheltered	2	0.15%
<b>Homeless - Total</b>	<b>1,337</b>	<b>100.00%</b>

### District ELL/LEP Percentages

ELL	ELL Count	ELL Percentage
No	1,333	99.70%
Yes	4	0.30%
<b>ELL - Total</b>	<b>1,337</b>	<b>100.00%</b>

### District Migrant Percentages

Migrant	Migrant Count	Migrant Percentage
No	1,337	100.00%
<b>Migrant - Total</b>	<b>1,337</b>	<b>100.00%</b>

### District Home Language Percentages

Language	Home Language Count	Home Language Percentage
Arabic	4	0.30%
Chinese; Zhongwen	1	0.07%



# KIPP Delta Public Schools

## Student Demographic Percentages

Excludes PK Students

**1,337 Total Active Students On 06/01/2017**

Language	Home Language Count	Home Language Percentage
English	1,328	99.33%
Mandarin	1	0.07%
Spanish	3	0.22%
<b>Home Language - Total</b>	<b>1,337</b>	<b>100.00%</b>

# BCPS Facility Overview

## Central Campus 4<sup>th</sup> – 6<sup>th</sup>

1124 W. Moultrie Drive

- Brick and mortar structure
- 63,000 square feet
- 29 classrooms
- Kitchen/Cafeteria/Auditorium
- Library
- PreK Building
- Multiple Office Spaces
- Green Space
- Purchased for \$806,000 through a \$1.2M interest only five year line of credit at 5.25%
- Phase I Renovations - completed Investment of \$1.3M via Donations
- **Phase II Renovations** – will include the second wing, the kitchen, and a playground area.
- Post renovations will serve K through 6<sup>th</sup>

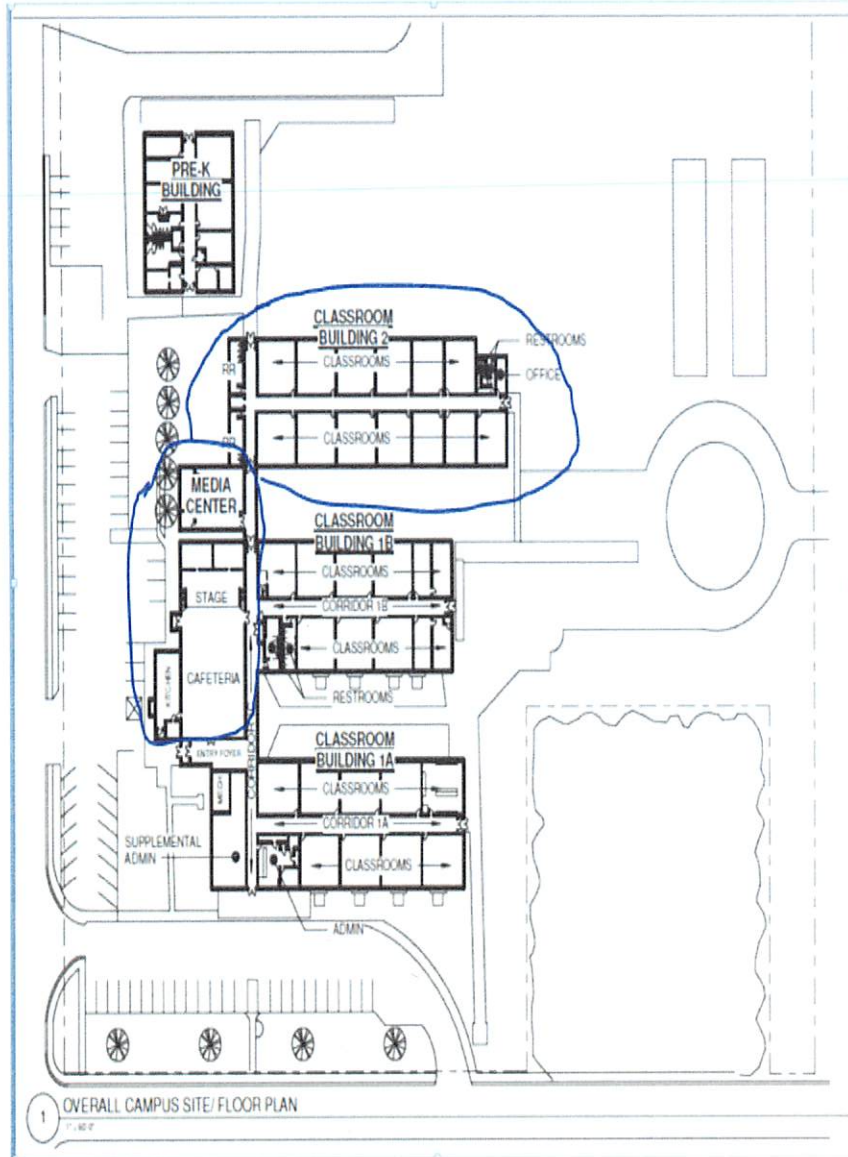

# Expansion Plans

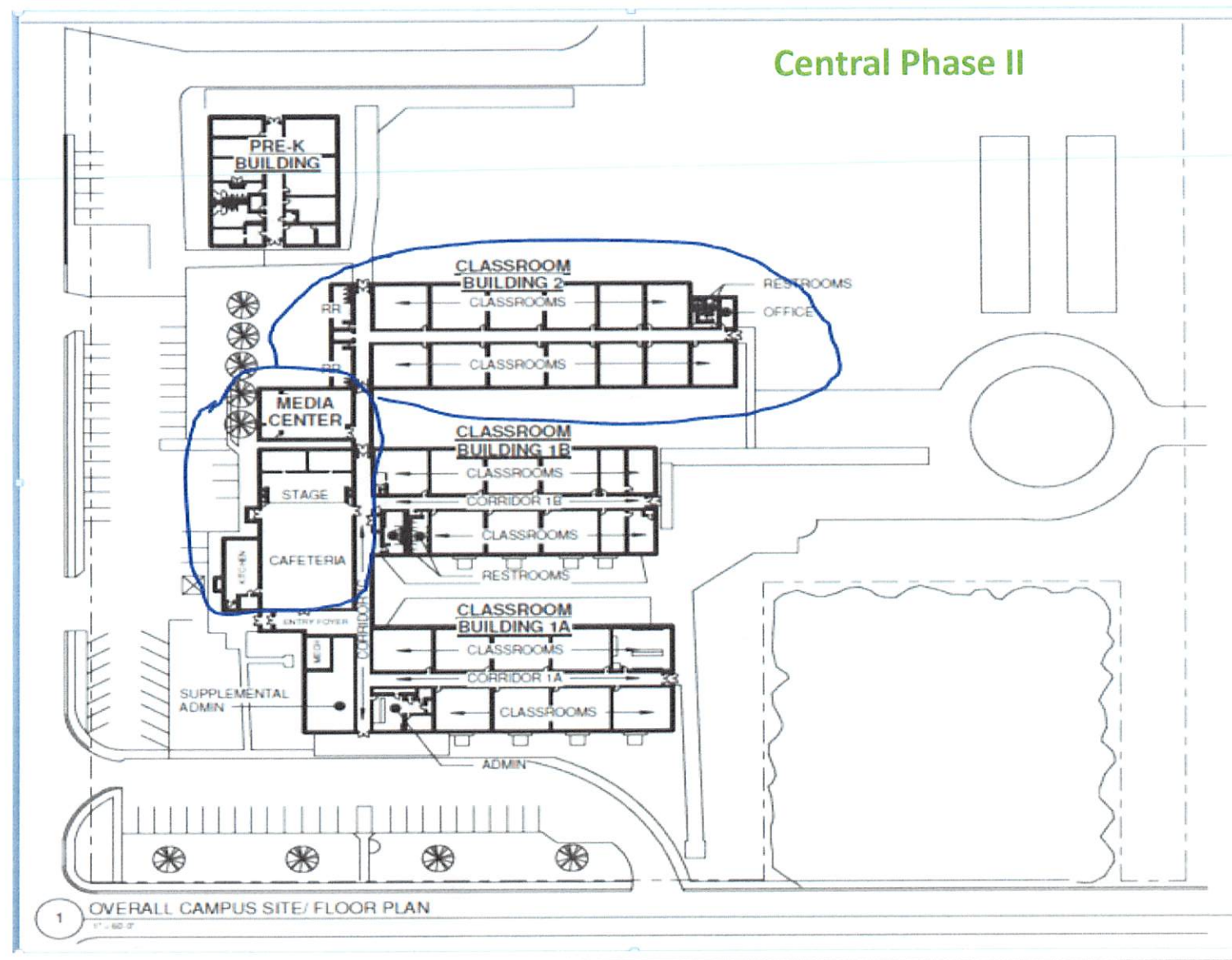

---

## Google Area View

---





## FACILITIES UTILIZATION AGREEMENT

*To be completed and submitted with an amendment request  
to add a new campus or relocate an existing campus*

Lessor(Owner): KIPP Delta Public Schools

Lessee(Tenant): N/A

Any information regarding affiliation, family ties, or other relationships between the Lessor (Owner) and Lessee (Tenant) must be disclosed with the facilities lease agreement.

Describe the present use of the facility:

The facility currently serves as the home of KIPP Blytheville College Preparatory School, which serves grades 4 - 6. The plan is to renovate additional wings of the facility to accommodate the additional grade levels.

Address of Premises: 1124 Moultrie Drive  
Blytheville, AR 72315

Square Footage: 63,000

Terms of Lease: N/A

Rental Amount: N/A

Contingency: The terms of this agreement are contingent upon  
KIPP Delta Public Schools

*Charter School*

receiving approval by the Authorizer to operate an open-enrollment public charter school at the premises identified.

Statutory Language Concerning No Indebtedness:

No indebtedness of any kind incurred or created by the open-enrollment public charter school shall constitute an indebtedness of the State of Arkansas or its political subdivisions, and no indebtedness of the open-enrollment public charter school shall involve or be secured by the faith, credit, or taxing power of the state or its political subdivisions. An open-enrollment public charter school shall not incur any debt, including any lease, without the prior review and approval of the Commissioner of Education.

We affirm that the facility is, or will be prior to charter occupancy, compliant with ADA/IDEA accessibility regulations, and will remain so while the charter occupies the location.

Lessee: N/A

By: \_\_\_\_\_ Date \_\_\_\_\_  
*Signature*

Lessor: KIPP Delta Public Schools

By:  Date 6/13/17  
*Signature*



## Desegregation Analysis

KIPP Blytheville College Preparatory School (KIPP Blytheville) is requesting an amendment to authorize it to change its grade levels from 4-12 to K-12, and to increase its enrollment cap from 810 students to a maximum enrollment cap of 1,100 students beginning in the 2018-2019 school year at its two (2) Blytheville campuses. KIPP Blytheville will continue to comply with all applicable federal and state statutory and regulatory requirements regarding the creation and maintenance of desegregated public schools.

KIPP Blytheville should continue to have no negative impact on the ability or the efforts of the BSD or any other Arkansas public school districts to comply with any existing court orders or statutory obligations to create and maintain a unitary system of desegregated public schools. The BSD has not submitted information to the Arkansas Department of Education (ADE) stating that it is a party to active desegregation lawsuits. Based upon its careful review pursuant to Ark. Code Ann. §6-23-106, KIPP Blytheville does not believe that the granting of its requested amendment will hamper, delay or in any way negatively affect the desegregation efforts of the BSD.

KIPP Blytheville will continue to comply with all federal and state laws concerning enrollment in a public school and in particular those laws specified to enrollment in a public charter school. The current (June 7, 2017) student population of KIPP Blytheville is 348 students in grade levels 4-11 (12<sup>th</sup> grade will be added in the 2017-2018 school year). The 2016-2017 school year student population of the BSD as maintained by the ADE Data Center is 2,111 students. KIPP Blytheville's student population is approximately 16.5% of the BSD student population.

KIPP Blytheville realizes it cannot exclude any student that may wish to attend due to race, gender, ethnicity, or any other prohibited reason. No conclusion can be inferred or drawn against KIPP Blytheville that there exists any intent to continue to operate a public school, by way of this amendment request, or in practice, that has a purpose or intent to create a racially segregated public school or likewise impact other public schools.



Enrollment:	1418	1426	1544	1714
	FY16 Actuals	Projected FY17 Actuals*	Draft FY18	Draft FY19
<b>Operating Revenue</b>				
State Funding	\$11,121,923	11,584,690	12,355,592	13,981,770
Facilities Funding	\$740,470	729,944	657,360	680,909
Federal Grants	\$3,593,962	3,881,956	3,601,464	3,502,016
School Activity Funding	\$192,616	129,454	61,073	63,623
Fundraising	\$2,187,128	1,850,000	1,750,000	2,000,000
Prior Year Carryover	\$748,794	178,664		-
KTC Carryover	\$0.00	-		-
Above & Beyond	\$398,906	143,577	818,650	648,650
<b>Total Operating Revenue</b>	<b>\$18,983,798</b>	<b>\$18,498,285</b>	<b>\$19,244,140</b>	<b>\$20,876,968</b>
<b>Operating Expense</b>				
Salaries & Benefits (minus Departments)	\$9,704,756	\$9,681,649	\$10,211,072	\$10,959,793
Staff Development & Associated Travel	\$357,482	\$337,773	\$295,400	\$301,308
Acknowledgement & Retention Activities	\$23,051	\$33,720	\$30,795	\$31,411
Interns, Stipends & TFA Fees	\$82,000	\$52,000	\$69,000	\$70,380
Staff Recruitment	\$113,683	\$39,501	\$35,635	\$36,348
<b>Total Staffing Expenses</b>	<b>\$10,280,973</b>	<b>\$10,144,643</b>	<b>\$10,641,902</b>	<b>\$11,399,240</b>
Textbooks & Core Curricula	\$165,994	\$77,376	\$108,496	\$120,442
Library Books & Supplemental Instructional Mat.	\$143,145	\$181,278	\$149,827	\$166,323
Testing & Exam Supplies	\$40,674	\$22,389	\$46,573	\$51,701
Classroom Materials & Supplies	\$74,919	\$68,992	\$55,842	\$61,990
Parental Involvement Act. (required )	\$9,603	\$26,589	\$19,100	\$21,203
Special Education	\$132,526	\$90,412	\$96,875	\$107,541
Experienced Based Field Lessons (w/ transport)	\$194,268	\$135,173	\$154,500	\$171,511
Student Activities	\$38,256	\$51,978	\$45,500	\$50,510
Student Uniforms	\$69,853	\$46,519	\$31,480	\$34,946
Student Recruitment	\$12,131	\$4,884	\$11,650	\$12,933
Athletics	\$67,289	\$61,742	\$61,950	\$63,771
Athletics Transportation	\$30,209	\$17,409	\$30,800	\$34,191
Music, Drama, & Art (w/ shuttle service)	\$46,442	\$39,755	\$24,345	\$27,025
Homeless Children (required)	\$2,804	\$3,190	\$1,482	\$1,645
Nursing & Wellness Services	\$4,995	\$7,975	\$12,450	\$13,821
<b>Total Student Services</b>	<b>\$1,033,107</b>	<b>\$835,661</b>	<b>\$850,870</b>	<b>\$939,554</b>
KIPP through College - Salaries	\$518,087	\$582,837	\$709,063	\$723,244
KIPP through College - Program	\$430,096	\$129,884	\$370,769	\$370,769
External Affairs - Salaries	\$282,589	\$269,011	\$365,533	\$372,844
External Affairs - Program	\$130,627	\$271,404	\$200,000	\$200,000
Custodial Services - Salaries	\$178,509	\$248,015	\$299,137	\$345,120
Custodial Services - Program	\$132,992	\$110,850	\$119,858	\$125,851
Student Transportation - Salaries	\$611,844	\$654,521	\$678,767	\$692,342
Student Transportation - Program	\$567,927	\$519,178	\$251,352	\$256,379



Enrollment:	1418	1426	1544	1714
	FY16 Actuals	Projected FY17 Actuals*	Draft FY18	Draft FY19
Child Nutrition - Salaries	\$377,326	\$563,092	\$651,204	\$724,228
Child Nutrition - Program	\$1,065,415	\$951,715	\$595,809	\$693,212
<b>Total Departments</b>	<b>\$4,295,410</b>	<b>\$4,300,507</b>	<b>\$4,241,492</b>	<b>\$4,503,989</b>
Office Expenses	\$185,655	\$228,852	\$131,142	\$144,256
Non-PD Travel Expenses	\$53,049	\$60,896	\$57,000	\$59,850
Other Operating Expenses	\$181,919	\$260,127	\$232,080	\$243,684
Professional Services	\$215,731	\$243,390	\$271,098	\$284,653
IT & Communications Support	\$441,940	\$516,099	\$437,992	\$481,791
Utilities	\$205,507	\$225,063	\$392,836	\$424,810
Insurance	\$144,528	\$171,789	\$251,263	\$261,263
Grounds	\$25,164	\$37,020	\$39,599	\$41,975
Maintenance	\$201,208	\$217,201	\$194,169	\$198,052
<b>Total Operating &amp; Professional Services</b>	<b>\$1,654,701</b>	<b>\$1,960,437</b>	<b>\$2,007,179</b>	<b>\$2,140,334</b>
Lease Payments (Facilities)	\$50,619	\$123,544	\$192,787	\$147,847
Debt Service	\$617,722	\$649,175	\$748,127	\$984,924
Rainy Day/Growth			\$262,145	\$417,539
Fixed Assets	\$69,259	\$18,819	\$87,118	\$90,000
All Other Assets Under \$1K	\$149,992	\$346,808	\$82,206	\$100,000
<b>Total Debt Service &amp; Assets</b>	<b>\$887,592</b>	<b>\$1,138,346</b>	<b>\$1,372,383</b>	<b>\$1,740,310</b>
<b>Total Cash Expenditures</b>	<b>\$18,151,783</b>	<b>\$18,379,594</b>	<b>\$19,113,826</b>	<b>\$20,723,428</b>
<b>Net Income</b>	<b>\$832,016</b>	<b>\$118,691</b>	<b>\$130,314</b>	<b>\$153,540</b>
* As of 5/31/17				
	FY16 Actuals	Projected FY17 Actuals*	Draft FY18	Draft FY19
<b>CASHFLOW - OPERATING</b>				
BEGINNING CASH - Operating	\$1,798,982	\$1,881,477	\$1,991,580	\$2,121,894
Expiring Cash Transferred to Revenue Section	\$748,794	\$509,933		
Cash After Transfer	\$1,050,188	\$1,371,544	\$1,991,580	\$2,121,894
Add: Adjusting Entries	-\$726	\$1,345		
Add Restricted Grant	\$0	\$500,000	\$0	\$0
Net Income/Loss	\$832,016	\$118,691	\$130,314	\$153,540
<b>Projected Ending Cash (Operating)</b>	<b>\$1,881,477</b>	<b>\$1,991,580</b>	<b>\$2,121,894</b>	<b>\$2,275,434</b>
Projected Days of Cash on Hand:	38	40	40.5	40.1

## 2016 ESEA DISTRICT REPORT KIPP DELTA PUBLIC SCHOOLS

**Superintendent:** SCOTT SHIREY  
**LEA:** 5440700  
**Enrollment:** 1411

**Attendance:** 96.38  
**Poverty Rate:** 100.00

**Address:** 415 OHIO STREET  
HELENA, AR 72342  
**Phone:** (870) 753-9035

<b>OVERALL DISTRICT STATUS:</b>	<b>2014 NEEDS IMPROVEMENT</b>
---------------------------------	-------------------------------

### PERCENT TESTED

PERCENT TESTED STATUS: <b>ACHIEVING</b>						
	ELA			MATHEMATICS		
ESEA Flexibility Indicators	# Attempted	# Expected	Percentage	# Attempted	# Expected	Percentage
All Students	1006	1013	99.31	1006	1013	99.31
Targeted Achievement Gap Group	1004	1011	99.31	1004	1011	99.31
ESEA Subgroups	# Attempted	# Expected	Percentage	# Attempted	# Expected	Percentage
African American	902	908	99.34	902	908	99.34
Hispanic	27	28	96.43	28	28	100.00
White	56	56	100.00	55	56	98.21
Economically Disadvantaged	1004	1011	99.31	1004	1011	99.31
English Language Learners	n < 10	n < 10	n < 10	n < 10	n < 10	n < 10
Students with Disabilities	83	84	98.81	82	84	97.62

### 2016 STUDENT PERFORMANCE -- ENGLISH LANGUAGE ARTS

ESEA Flexibility Indicators	# Achieved	# Tested	Percentage	State Average % Achieved
All Students	346	933	37.08	47.87
Targeted Achievement Gap Group	346	933	37.08	36.87
ESEA Subgroups	# Achieved	# Tested	Percentage	State Average % Achieved
African American	297	840	35.36	27.81
Hispanic	13	27	48.15	41.05
White	25	46	54.35	55.31
Economically Disadvantaged	346	933	37.08	37.65
English Language Learners	n < 10	n < 10	n < 10	30.15
Students with Disabilities	12	81	14.81	12.35

### 2016 STUDENT PERFORMANCE -- MATHEMATICS

ESEA Flexibility Indicators	# Achieved	# Tested	Percentage	State Average % Achieved
All Students	303	931	32.55	43.35
Targeted Achievement Gap Group	303	931	32.55	34.25
ESEA Subgroups	# Achieved	# Tested	Percentage	State Average % Achieved
African American	256	839	30.51	23.53
Hispanic	14	27	51.85	38.01
White	23	45	51.11	50.35
Economically Disadvantaged	303	931	32.55	34.76
English Language Learners	n < 10	n < 10	n < 10	31.69
Students with Disabilities	15	80	18.75	12.35

### 2015 SCHOOL GRADUATION RATE

ESEA Flexibility Indicators	# Actual Graduates	# Expected Graduates	Percentage	2015 State Average Percentage
All Students	35	43	81.40	85.71
Targeted Achievement Gap Group	26	34	76.47	82.59
Three Year Average Performance	# Actual Graduates	# Expected Graduates	Percentage	2015 State Average Percentage
All Students	112	126	88.89	85.87
Targeted Achievement Gap Group	90	103	87.38	82.01
ESEA Subgroups	# Actual Graduates	# Expected Graduates	Percentage	2015 State Average Percentage
African American	34	42	80.95	78.66
Hispanic	n < 10	n < 10	n < 10	85.43
White	n < 10	n < 10	n < 10	88.13
Economically Disadvantaged	26	34	76.47	82.42
English Language Learners	n < 10	n < 10	n < 10	86.45
Students with Disabilities	n < 10	n < 10	n < 10	82.56

## 2016 ESEA DISTRICT REPORT KIPP DELTA PUBLIC SCHOOLS

**Superintendent:** SCOTT SHIREY  
**LEA:** 5440700  
**Enrollment:** 1411

**Attendance:** 96.38  
**Poverty Rate:** 100.00

**Address:** 415 OHIO STREET  
HELENA, AR 72342  
**Phone:** (870) 753-9035

### Percent Tested: Source and Use of Enrollment

For percent tested and school/district performance calculations, student enrollment files were downloaded from eSchool via TRIAND to establish the students expected to test. These files were downloaded April 29, 2016.

When students' test and enrollment records were matched by school and student state identifier, the demographic values from the enrollment files were used in ESEA calculations.

When a student had a test record, but a matching enrollment record was not found, the demographic values from the student's test record were used in ESEA calculations.

When a student had an enrollment record that did not match a test record, the demographic values from the student's enrollment record were used in ESEA percent tested calculations.

### District Performance

The district performance results in this report include students who completed a full academic year (not highly mobile) and completed a regular or alternate assessment. Students who were considered highly mobile were excluded from the calculations. All grades are included in the district performance for each subject.

### Average State Performance

The average state performance statistics listed in this report include students who completed a full academic year (not highly mobile) and completed a regular or alternate assessment. Students who were considered highly mobile were excluded from the calculations. All grades are included in the state averages for each subject.

**The school performance results in this report include students who completed a full academic year (not highly mobile) and completed a regular or an alternate assessment.**

**Report created on: 11/14/2016**





# Arkansas Department of Education

*Transforming Arkansas to lead the nation in student-focused education*

Johnny Key  
*Commissioner*

June 28, 2017

State Board  
of Education

Scott Shirey, Executive Director  
KIPP Delta Public Schools  
415 Ohio Street  
Helena, Arkansas 72342

Dr. Jay Barth  
*Little Rock*  
Chair

## Re: Charter Authorizing Panel-Amendment Request

Joe Black  
*Newport*  
Vice Chair

Dear Mr. Shirey:

Susan Chambers  
*Bella Vista*

I received your letter dated June 6, 2017, requesting a waiver of Section 4.02.3 of the ADE Rules Governing Public Charter Schools that states requests for amendments will be heard at the February and October authorizer meetings, and Section 4.02.5 of the rules that requires amendment requests to be submitted thirty-five (35) days before the authorizer meeting where the amendment request will be heard.

Charisse Dean  
*Little Rock*

Dr. Fitz Hill  
*Little Rock*

KIPP Delta is requesting amendments to expand its Blytheville campuses to serve students in grades K-3 and to increase its enrollment. Currently the campuses serve grades 4-12 with a maximum enrollment of 810. KIPP desires to expand to K-12 with a maximum enrollment of 1,100 for the 2018-2019 school year. As you stated, KIPP Delta is asking for a waiver in order to have its amendment request considered by the Charter Authorizing Panel at the July hearing.

Ouida Newton  
*Poyen*

Mireya Reith  
*Fayetteville*

R. Brett Williamson  
*El Dorado*

Pursuant to Section 4.02.7 of the ADE Rules Governing Public Charter Schools, I will grant a waiver of the February/October amendment hearing dates and the 35-day requirement in order to allow this amendment request to appear on the July agenda of the Charter Authorizing Panel.

Diane Zook  
*Melbourne*

Sincerely,

Johnny Key  
Commissioner

Four Capitol Mall  
Little Rock, AR  
72201-1019  
(501) 682-4475  
ArkansasEd.gov

*An Equal  
Opportunity  
Employer*



# MEMO

---

DATE: July 10, 2017  
TO: Charter Authorizer  
FROM: ADE Legal Services Staff  
SUBJECT: Desegregation Analysis of Amendment Request for Kipp Delta - Blytheville

---

## I. INTRODUCTION

Kipp Delta of Blytheville is an open-enrollment charter school located in within the boundaries of the Blytheville School District (BSD). The school is approved to serve grades four through twelve (4-12) with an enrollment cap of 810 at the Blytheville campus. Kipp Delta Blytheville is requesting to expand its grades to serve students in grades kindergarten through third (K-3). Kipp Delta Blytheville also requests an enrollment increase from 810 to 1100 to accommodate the additional grades.

## II. STATUTORY REQUIREMENTS

Although Ark. Code Ann. § 6-23-106 requires the authorizer to carefully analyze the impact of any new proposed charter school on the efforts of public school districts to achieve and maintain unitary systems, it does not require the authorizer to conduct an analysis of proposed amendments to an existing charter. However, Ark. Code Ann. § 6-23-106(c) states that the State Board "shall not approve any ... act or any combination of acts that hampers, delays, or in any manner negatively affects the desegregation efforts of a public school district or public school districts in this state."

## III. INFORMATION SUBMITTED BY THE APPLICANT AND THE AFFECTED SCHOOL DISTRICT

A desegregation analysis submitted by the charter school is attached as Exhibit A. To date, no desegregation-related opposition to the charter amendment has been received.

## IV. DATA FROM THE DEPARTMENT

The October 1, 2016, enrollment for the traditional public school districts in Mississippi County is as follows:



	2 or More Races	Asian	Black/ African American	Hispanic	Native Am. Hawaiian/ Pacific Islander	White	Totals
<b>Affected School Districts</b>							
Armored School District	0	23	25	19	2	365	434
	0.00%	5.30%	5.76%	4.38%	0.46%	84.10%	--
Blytheville School District	3	6	1,713	68	4	317	2,111
	0.14%	0.28%	81.15%	3.22%	0.19%	15.02%	--
Gosnell School District	44	2	327	85	1	872	1,331
	3.31%	0.15%	24.57%	6.39%	0.08%	65.51%	--
Manila School District	6	1	7	57	1	985	1,057
	0.57%	0.09%	0.66%	5.39%	0.09%	93.19%	--
Osceola School District	16	8	931	45	0	157	1,157
	1.38%	0.69%	80.47%	3.89%	0.00%	13.57%	--
Rivercrest School District	21	1	356	92	2	734	1,206
	0.57%	0.09%	0.66%	5.39%	0.09%	93.19%	--
<b>DISTRICTS TOTAL</b>	<b>90</b>	<b>41</b>	<b>3,359</b>	<b>366</b>	<b>10</b>	<b>3,430</b>	<b>7,296</b>
	<b>1.23%</b>	<b>0.56%</b>	<b>46.04%</b>	<b>5.02%</b>	<b>0.14%</b>	<b>47.01%</b>	<b>--</b>

Source: ADE Data Center, Oct. 1, 2016 Enrollment

#### IV. ANALYSIS FROM THE DEPARTMENT

“Desegregation” is the process by which a school district eliminates, to the extent practicable, the lingering negative effects or “vestiges” of prior *de jure* (caused by official action) racial discrimination. The goal of a desegregation case with regard to assignment of students to schools is to “achieve a system of determining admission to the public schools on a non-racial basis.” *Pasadena City Board of Education v. Spangler*, 427 U.S. 424, 435 (1976) (quoting *Brown v. Board of Education*, 349 U.S. 294, 300-301 (1955)).

The ADE is unaware of any active desegregation orders applicable to the Armored, Blytheville, Gosnell, Manila, Osceola, or Rivercrest school districts, and no desegregation-related opposition was received from any of the affected school districts.

#### V. CONCLUSION

As stated above, Arkansas law does not allow the authorizer to approve any public charter school that “hampers, delays, or in any manner negatively affects the desegregation efforts” of a public school district. Ark. Code Ann. § 6-23-106(c). The Supreme Court noted in *Missouri v. Jenkins*, 515 U.S. 70, 115 (1995):

[I]n order to find unconstitutional segregation, we require that plaintiffs “prove all of the essential elements of *de jure* segregation -- that is, stated

simply, a current condition of segregation resulting from *intentional state action directed specifically* to the [allegedly segregated] schools." *Keyes v. School Dist. No. 1*, 413 U.S. 189, 205-206 (1973) (emphasis added). "[T]he differentiating factor between *de jure* segregation and so-called *de facto* segregation . . . is purpose or *intent* to segregate." *Id.*, at 208 (emphasis in original).

It is difficult to conclude, from data currently available, that the proposal of the charter school is motivated by an impermissible intent to segregate schools, or that approval would hamper, delay or negatively affect the desegregation efforts of the affected school districts.



### **Desegregation Analysis**

KIPP Blytheville College Preparatory School (KIPP Blytheville) is requesting an amendment to authorize it to change its grade levels from 4-12 to K-12, and to increase its enrollment cap from 810 students to a maximum enrollment cap of 1,100 students beginning in the 2018-2019 school year at its two (2) Blytheville campuses. KIPP Blytheville will continue to comply with all applicable federal and state statutory and regulatory requirements regarding the creation and maintenance of desegregated public schools.

KIPP Blytheville should continue to have no negative impact on the ability or the efforts of the BSD or any other Arkansas public school districts to comply with any existing court orders or statutory obligations to create and maintain a unitary system of desegregated public schools. The BSD has not submitted information to the Arkansas Department of Education (ADE) stating that it is a party to active desegregation lawsuits. Based upon its careful review pursuant to Ark. Code Ann. §6-23-106, KIPP Blytheville does not believe that the granting of its requested amendment will hamper, delay or in any way negatively affect the desegregation efforts of the BSD.

KIPP Blytheville will continue to comply with all federal and state laws concerning enrollment in a public school and in particular those laws specified to enrollment in a public charter school. The current (June 7, 2017) student population of KIPP Blytheville is 348 students in grade levels 4-11 (12<sup>th</sup> grade will be added in the 2017-2018 school year). The 2016-2017 school year student population of the BSD as maintained by the ADE Data Center is 2,111 students. KIPP Blytheville's student population is approximately 16.5% of the BSD student population.

KIPP Blytheville realizes it cannot exclude any student that may wish to attend due to race, gender, ethnicity, or any other prohibited reason. No conclusion can be inferred or drawn against KIPP Blytheville that there exists any intent to continue to operate a public school, by way of this amendment request, or in practice, that has a purpose or intent to create a racially segregated public school or likewise impact other public schools.

## **THE EXCEL CENTER**

SPONSORING ENTITY: Goodwill Arkansas Education Initiatives, Inc.

### **MISSION STATEMENT**

The mission of The Excel Center is to provide adults the opportunity and support to earn a high school diploma and begin postsecondary education while developing career paths in sectors of the local economy that offer better-than-average employment and growth opportunities.

### **CURRENT DATA**

Maximum Enrollment	125
Approved Grade Levels	9-12
Grades Served 2017-2018	9-12

### **BACKGROUND**

Authorized	October 19, 2016
Contract Expiration	June 30, 2022



## Charter Amendment Request Form

**Charter Name:** The Excel Center

**LEA Number:** 6058700      **Phone Number:** 501.372.5100      **Submission Date:** 06/12/2017

**Charter Leader:** LaShawnDa Noel

**Email Address:** Inoel@goodwillar.org

### Type of Amendment Requested:

☒ **Waiver**

**Waiver Topic:** School Year Dates

#### Statute/Standard/Rule to be Waived

##### Arkansas Code Annotated

- | Code Number | Code Title  |
|-------------|---|
| ● 6-10-106  | Uniform dates for beginning and end of school year. |

#### Rationale for Waiver

To ensure that the renovation and new construction at the facility is successfully completed by October 2017. If this waiver is not approved it may negatively impact educational services offered by the charter school.

**Waiver Topic:** Monthly Board Meetings

#### Statute/Standard/Rule to be Waived

##### Arkansas Code Annotated

- | Code Number         | Code Title  |
|---------------------|---|
| ● 6-13-619(a)(1)    | Monthly Board Meetings  |
| ● 6-13-619(c)(1)(A) | Requiring a board member to be physically present at a meeting to be counted for the purposes of a quorum or to vote. |

#### Rationale for Waiver

Due to the geographic location of board members, we are requesting this waiver to afford the board the opportunity to meet on a quarterly basis and to participate by telephone or electronically. If this waiver is not approved it may negatively impact educational services offered by the charter school.

June 12, 2017

Commissioner Johnny Key  
Arkansas Department of Education  
Four Capitol Mall, Room 304-A  
Little Rock, AR 72201

Re: Request for Charter Amendment Hearing in July 2017

Dear Commissioner Key:

I am writing to request that the Charter Authorizing Panel consider a charter amendment request for the Excel Center at Goodwill at its meeting on July 19, 2017. I am requesting a waiver of the ADE Rules of Governing Public Charter Schools Section 4.02.3, in accordance with Section 4.02.7 of the same rules. I would also like to include waiver of the 35-calendar day deadline to submit the amendment request for the July hearing.

In July 2017, we are seeking to appear before the Charter Authorizing Panel to request an amendment to the Excel Center at Goodwill charter changing our school year dates and the method of school board member meetings. These changes would allow for flexibility from the statutory provision in order that the renovation of the facility can be up to standard to receive our students, and the board could meet on a quarterly basis and participate by telephone or electronic communication due to the geographic location of members. Not receiving these requests may negatively affect the continuation of educational services offered by the charter school.

Sincerely,

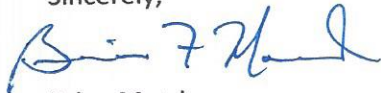

Brian Marsh  
Chief Operating Officer



Changing lives through education, training and employment.

7400 Scott Hamilton Drive, Suite 50, Little Rock, AR 72209 | 501.372.5100 office | 501.372.5112 fax | GoodwillAR.org





# Arkansas Department of Education

*Transforming Arkansas to lead the nation in student-focused education*

---

Johnny Key  
*Commissioner*

June 28, 2017

State Board  
of Education

Dr. Jay Barth  
*Little Rock*  
Chair

Brian Marsh, Chief Operating Officer  
The Excel Center  
7400 Scott Hamilton Drive, #50  
Little Rock, Arkansas 72209

**Re: Charter Authorizing Panel-Amendment Request**

Joe Black  
*Newport*  
Vice Chair

Dear Mr. Marsh:

Susan Chambers  
*Bella Vista*

I received your letter dated June 12, 2017, requesting a waiver of Section 4.02.3 of the ADE Rules Governing Public Charter Schools that states requests for amendments will be heard at the February and October authorizer meetings, and Section 4.02.5 of the rules that requires amendment requests to be submitted thirty-five (35) days before the authorizer meeting where the amendment request will be heard.

Charisse Dean  
*Little Rock*

Dr. Fitz Hill  
*Little Rock*

The Excel Center is requesting amendments to change the school year dates and to change the method of school board meetings. As you stated, The Excel Center is asking for a waiver in order to have its amendment request considered by the Charter Authorizing Panel at the July hearing.

Ouida Newton  
*Poyen*

Mireya Reith  
*Fayetteville*

Pursuant to Section 4.02.7 of the ADE Rules Governing Public Charter Schools, I will grant a waiver of the February/October amendment hearing dates and the 35-day requirement in order to allow this amendment request to appear on the July agenda of the Charter Authorizing Panel.

R. Brett Williamson  
*El Dorado*

Diane Zook  
*Melbourne*

Sincerely,

Johnny Key  
Commissioner

Four Capitol Mall  
Little Rock, AR  
72201-1019  
(501) 682-4475  
ArkansasEd.gov

*An Equal  
Opportunity  
Employer*